

4 Inch

Floating Gimbal Light

- Adjustable up to 90° tilt.
- Type IC, Air-Tight - No Housing Required
- Made of durable steel material
- I.C. rated for direct contact with insulation
- Suitable for DAMP LOCATION
- Ideal for sloped ceilings, wall washing, highlighting artwork, task or general lighting



Slide Switch Adjustable CCT
Can be set to 2700K,3000K,
3500K,4000K,5000K

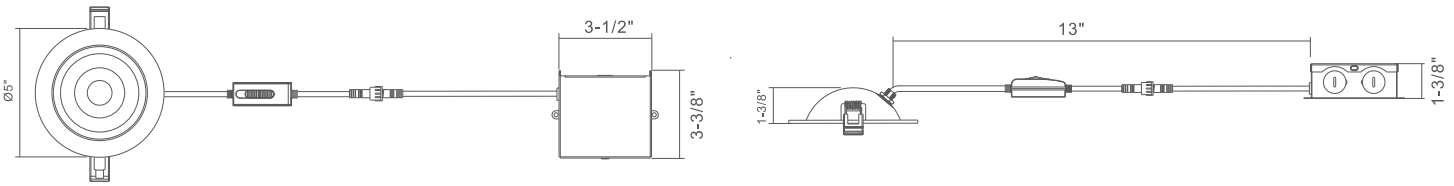

SPECIFICATIONS	
Application	Recessed Ceiling Mount
Watts	12W
CRI	90Ra+
Color Temperature(K)	5CCT Selectable 2700K to 5000K
Light Output(lm)	1000lm
Default Driver Input	AC120V, 60Hz
Dimming	Triac Dimming
Power Factor	>0.9
Approved Location	Damp Location
Air Tight	Yes
Operating Temp.	(-4°F~104°F) -20~40°C
Beam Angle	38°

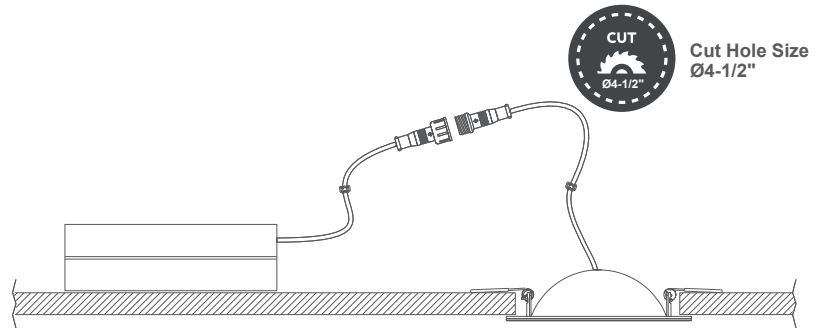

Ordering

MODEL	CCT	FINISH
TL4R-IC-12W-5CCT-D90-MW	5CCT selectable (2700-5000K)	MW (Matte White)

Accessories

<p>Mounting Plate</p> <p>R2.5-4-6-NC See Page 60</p>	<p>Mounting Plate</p> <p>R4-NC See Page 60</p>	<p>Emergency Driver</p> <p>BL-ELD-15W See Page 60</p>
--	--	---